



ACTUS-XL 35 Kit

View camera

INSTRUCTION MANUAL

EN

Please read this manual carefully before using the ACTUS-XL 35 Kit!

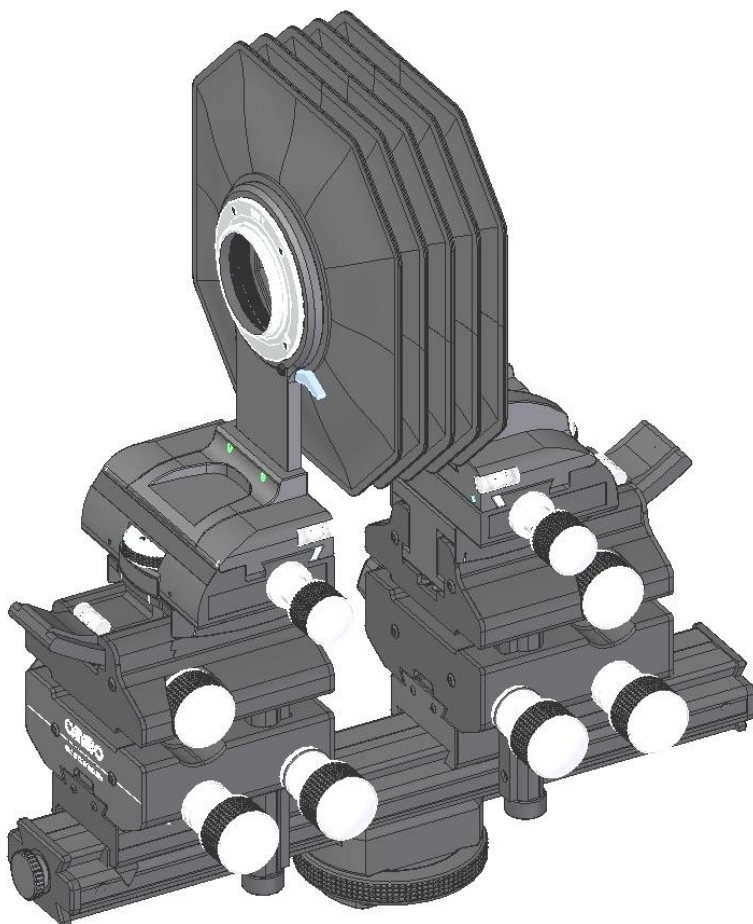

CAMBO

Thank you for purchasing a Cambo product.

The Cambo ACTUS-XL is a new view camera system, evolved from the ACTUS and ULTIMA series. Where the Actus Mini excels in being the lightest and smallest camera platform, the ACTUS-XL system is a fusion of both the Actus and Ultima camera platforms, maintaining full camera movements. Modular is the keyword. The Actus-XL accepts all Actus lens plates and lens adapters, sharing the same mount. On the rear standard you find an easy exchangeable frame holder for either a digital back or a DSLR/Mirror less camera body. Both front and rear standard have lateral movements, vertical adjustments, swings as well as tilts, all for optimized control over perspective and selective sharpness.

With the use of full view camera movements the photographer will be able to be more versatile, be more creative and will be getting more professional results much faster than before.

Configuration of the ACTUS-XL 35 Kit:

- Actus-XL View camera body
- ACXL-960 Lens plate holder (Without lens plate)
- ACXL-965 Bayonet frame (Optional camera bayonet)
- AC-214 Extended bellow (250mm extension)
- UL-30 300mm monorail

1. Key Features

Expand the usability of your camera system

- View camera movement for selective sharpness
- Rear Shift movement to stitch wider angle images
- Focal plane shifts to increase file size
- Rotation Landscape/portrait built-in
- Built-in macro extension
- Use of various lens designs
- Interchangeable bellows options

Enhance your creativity with the Cambo ACTUS-XL-35

- Use tilts and swings to place exact sharpness where needed
- Create selective optical un-sharpness
- Use more of the image circle of your lenses
- Stitch your images without changing the lens position
- Focus closer and enlarge your subject without extension rings
- Experiment with other system lenses and medium format lenses

Experience the possibilities of the Cambo ACTUS-XL-35

- Front and Rear standards offer geared tilt / swing both on-axis
- Lens plates are quickly interchangeable
- Quick slide focus adjustment rail
- Fine focus adjustment with precision gearing on both standards
- Shift movements vertical/horizontal in the focal plane
- Zero clicks on all movements
- Image centered rotation from landscape to portrait
- Exchangeable bayonets for Sony E-Mount, Nikon F, Canon EOS, Fuji X-series, Micro 4/3, Olympus OMD, Leica-M, Pentax-K, Canon-M, Olympus-OMD

2. Cambo ACTUS-XL-35 Specifications

Size L/W/H:	31x14,5x31,5cm
Weight:	4800 grams
Swing:	+/- 20° both front and rear
Tilt:	+/- 20° both front and rear
Shift vertical:	40mm (20/20) both front and rear
Shift horizontal:	50mm (25/25) both front and rear
Max extension:	up to 185mm (Sony E-mount)
(Lens plate to sensor)	up to 205mm (Nikon F-mount)
	Up to 201mm (Canon EOS-mount)
Monorail extensions:	+150mm, +250mm, +420mm
Available colors:	Black anodized

3. Warnings

- ⚠ Due to the modularity of the Actus camera system, many camera-lens combinations are possible. Please beware that there is a possibility, with some camera-lens combinations, that the rear element of the lens collides with the rear standard or attached camera. Please note that Cambo is not responsible for any damage done to the Actus, lens or camera, due to improper or careless use.
- ⚠ Before changing the camera orientation from landscape to portrait or vice-versa, ensure that there is enough clearance between the camera body and the rear housing of the Actus. If necessary (this depends on the camera body is used) use the vertical shift to lift the camera to gain more clearance.
- ⚠ Ensure that there is enough clearance between the camera body and the rear housing of the Actus, before dismounting the camera body.
- ⚠ (Over)exposure to direct sunlight or heat sources will damage the leather bellows. Keep/store the leather bellows in a cool, dry, dust free and ventilated place.
- ⚠ The Actus uses disc magnets to mount the bellows. These permanent magnets (magnetism N45) could cause temporary or permanent damage to equipment¹ sensitive to magnetism like magnetic cards (credit card, ATM card).
- ⚠ Beware that some combinations of swing, tilt, shift and focus adjustments can dismount the bellows.

¹ Please note that memory cards are not magnetic data carriers and will therefore not be damaged by static magnetic fields.

4. Operating instructions

Actus-XL operation knobs, right hand side

1. Camera mount (interchangeable bayonet)
2. Unlock lever camera orientation
3. Camera holder dovetail
4. Rear swing adjustment knob
5. Rail extension
6. Front lateral shift adjustment knob
7. Front on-axis tilt adjustment knob
8. Front fine focus adjustment knob
9. Front Rise and fall adjustment knob
10. Rear lateral shift adjustment knob
11. Adjustable tripod mounting block
12. Rear rise and fall adjustment knob
13. Rear fine focus adjustment knob
14. Rear on-axis tilt adjustment knob

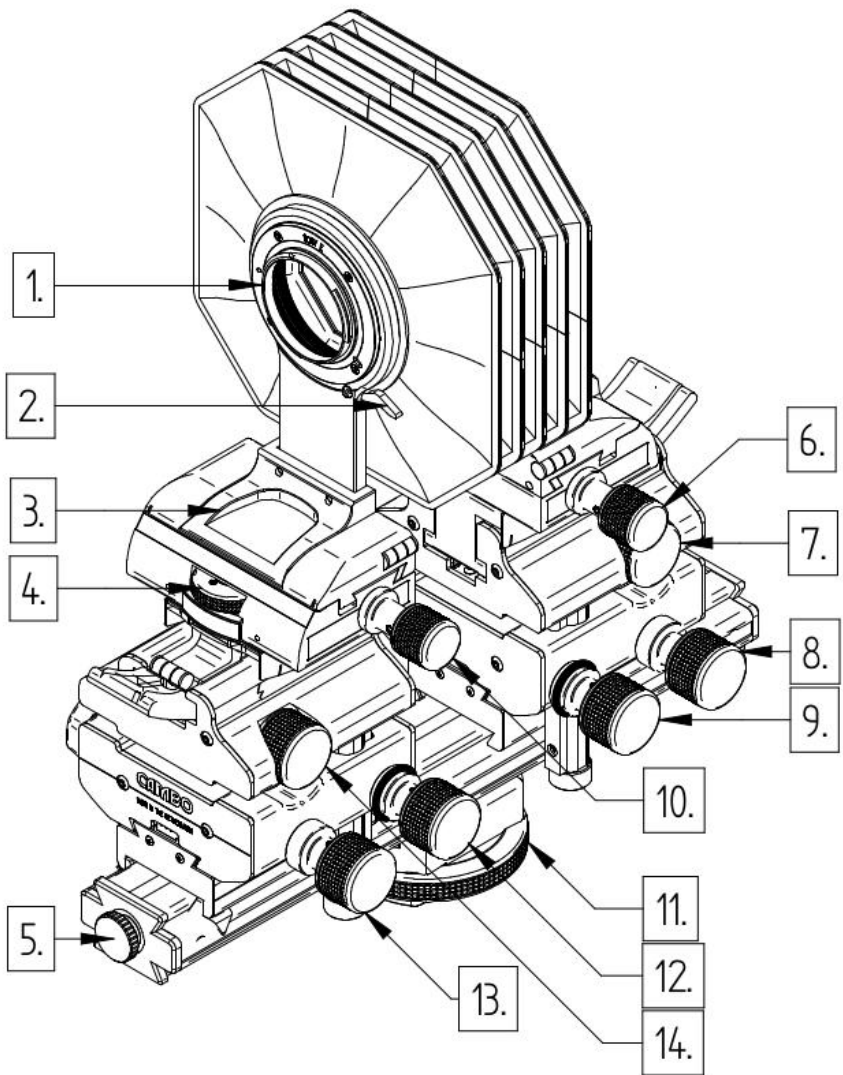

Figure 1 Actus-XL, Right hand side

Actus-XL operation knobs, left hand side

15. Actus lens panel
16. Lens holder dovetail
17. Lens panel (un)locking lever
18. Front swing adjustment knob
19. Rear dove tail adjustment screws²
20. Locking knob rear fine focus adjustment
21. Locking knob rear fast focus adjustment
22. Locking knob rear rise and fall movement
23. Front dove tail adjustment screws²
24. Locking knob front rise and fall movement
25. Locking knob front fine focus adjustment
26. Locking knob front fast focus adjustment

² Behind these screws are plastic studs that lock the dovetails in place without damaging it. Cambo supplies these spare studs in case of loss.

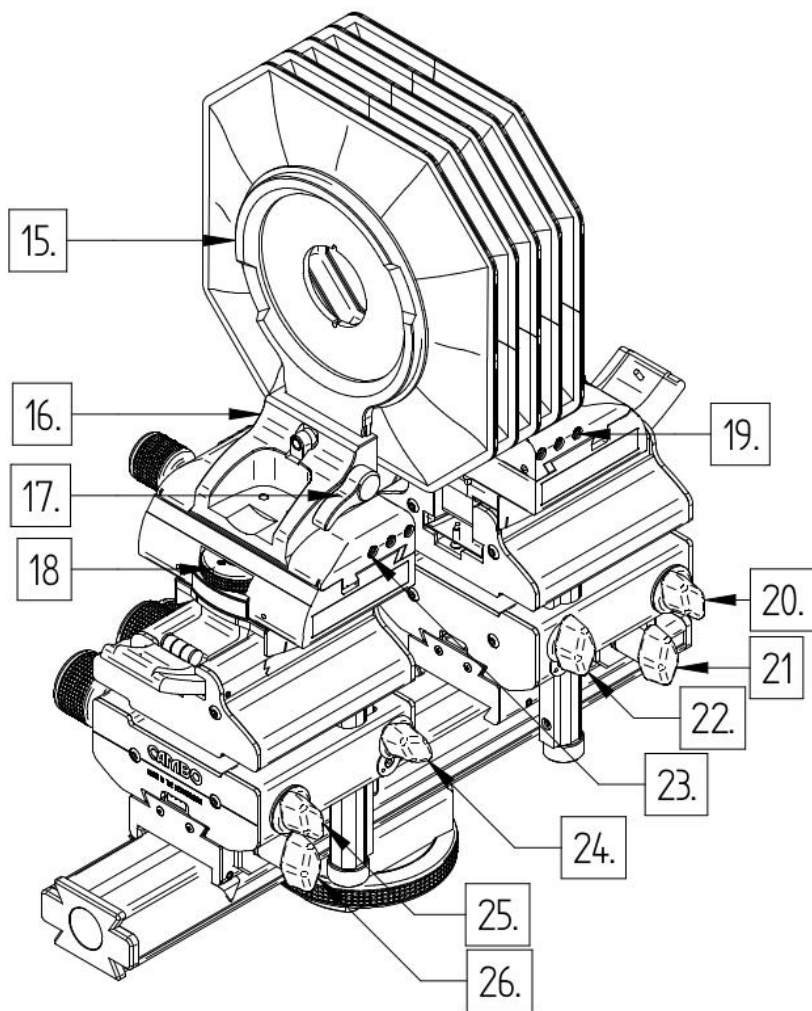

Figure 2 Actus-XL, Left hand side

Cambo R&D February 2017

This manual is prepared by Cambo with care, although no responsibility, financially or otherwise, is accepted for any consequences arising out of the use of this manual or this material. All specifications in this manual are subject to change without notice.

CAMBO Fotografische Industrie B.V.

P.O. Box 200	8260 AE
Haatlanderdijk 45	8263 AP
Kampen,	The Netherlands
Telephone:	31(0)38-3314644
Telefax:	31(0)38-3315110
Email:	info@cambo.com
Cambo website:	www.cambo.com
